



CATENE DI SOLLEVAMENTO E A RULLI LEAF AND ROLLER CHAINS

CATENE DI SOLLEVAMENTO.....	149
<i>LEAF CHAINS</i>	
CATENE ANTICORROSIONE DELTA-Z.....	152
<i>DELTA-Z ANTI-CORROSION CHAINS</i>	
GIUNZIONI CATENE SOLLEVAMENTO.....	152
<i>LINKS FOR LEAF CHAINS</i>	
CALIBRI PER CATENE.....	152
<i>CHAIN WEAR GAUGE</i>	
PERNI PER TIRANTI.....	153
<i>PINS FOR CHAIN ATTACHMENTS</i>	
TIRANTI PER CATENE SOLLEVAMENTO.....	154
<i>CHAIN END ATTACHMENTS</i>	
CATENE CON PLASTICHE LATERALI.....	155
<i>CHAINS WITH PLASTIC SIDEWALLS</i>	
CATENE CON PLASTICHE CENTRALI.....	156
<i>CHAINS WITH CENTRAL INSERTS</i>	
CATENE CON GUIDA TUBO A "C".....	157
<i>CHAINS WITH "C" HOSE GUIDE</i>	
CATENE FUORI STANDARD.....	157
<i>WORKS STANDARD CHAINS</i>	
PERNI SPECIALI.....	157
<i>SPECIAL CHAIN PINS</i>	
CATENE A RULLI EUROPEE.....	158
<i>EUROPEAN ROLLER CHAINS</i>	
CATENE A RULLI AMERICANE.....	159
<i>AMERICAN ROLLER CHAINS</i>	

- Tutte le catene sono certificate •
- Le catene vengono fornite tagliate su misura o in bobine intere •

- All the chains are certified •
- The chains are available in reels or cut to length •

Per identificare un tipo di catena Fleyer standard vi consigliamo di misurare le seguenti quote e di comunicarcele per potervi assistere nella scelta.

We can help you to identify any type of standard leaf chain. Quote the following dimensions and inform us.

Combinazione / Lacing	(vedi sotto / see below)
P (passo / pitch) mm
d (diametro perno / pin diameter) mm
b4 (larghezza totale / overall width) mm
e (spessore piastra / leaf thickness) mm
h2 (larghezza piastra / leaf width) mm

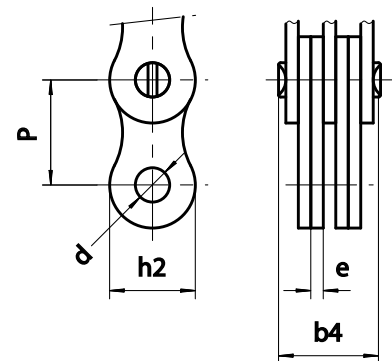

Combinazioni standard / Standard lacings

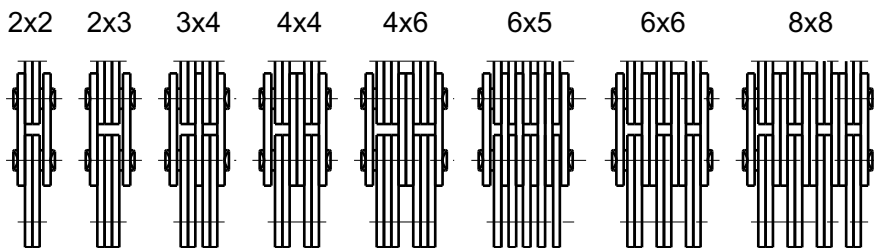

CATENE DI SOLLEVAMENTO LEAF CHAINS



3

Catene di sollevamento di alta qualità conformi alla norma ISO4347. Montate in origine dai più importanti costruttori. Carico di rottura minimo garantito superiore ai valori delle normative.

High quality leaf chains to ISO4347. O.E. on the forklift trucks from the leading manufactures. Minimum tensile strength guaranteed higher than standard value.

Art. Part no.	Tipo Type	Passo Pitch P	Comb. Lacing	Dimensioni Dimensions				Resist. min trazione Min tensile strength kN		Massa Weight kg/m
				b4	h2	d	e	Std.	SEDIS	
18200	AL422	12,7 (1/2")	2x2	8,20	9,8	4,01	1,55	15	16,5	0,35
18201	AL444		4x4	14,60				30	33,0	0,70
18202	AL466		6x6	21,00				45	49,5	1,01
18203	AL522	15,875 (5/8")	2x2	10,70	12,6	5,13	2,05	25	27,0	0,65
18204	AL544		4x4	19,10				50	54,0	1,25
18205	AL566		6x6	27,40				75	81,0	1,85
18206	AL622	19,05 (3/4")	2x2	12,30	14,8	5,99	2,40	34	38,0	0,76
18207	AL644		4x4	22,30				68	76,0	1,50
18208	AL666		6x6	32,40				102	114,0	2,25
18208A	AL688		8x8	42,50				160,0	3,00	
18209	AL822	25,4 (1")	2x2	17,00	19,9	7,96	3,30	59	65,7	1,50
18210	AL844		4x4	30,60				118	131,4	2,80
18211	AL866		6x6	43,80				177	197,1	4,10
18212	AL1022	31,75 (1" 1/4)	2x2	20,80	24,9	9,56	4,10	86	108,7	2,52
18213	AL1044		4x4	37,40				172	217,4	4,95
18214	AL1066		6x6	54,00				258	326,1	7,35
18215	AL1222	38,1 (1" 1/2)	2x2	24,40	30,0	11,14	4,90	122,5	154	3,50
18216	AL1244		4x4	44,20				245	308	6,90
18217	AL1266		6x6	64,00				367,5	462	10,30
18218	AL1422	44,45 (1" 3/4)	2x2	28,50	35,7	12,74	5,80	154,5	208,5	4,65
18219	AL1444		4x4	51,90				309	417	9,45
18220	AL1466		6x6	75,10				463,5	625,5	14,10
18221	AL1622	50,8 (2")	2x2	31,90	40,5	14,31	6,55	195,0	263,0	5,70
18222	AL1644		4x4	58,40				390,0	526,0	11,70
18223	AL1666		6x6	84,70				585,0	789,0	17,40

Serie
AL



Dimensioni / Dimensions

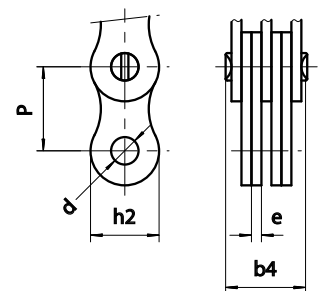

Serie

BL
LH



Dimensioni / Dimensions

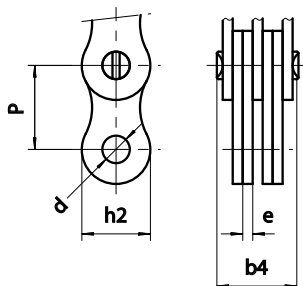

Art. Part no.	Tipo Type		Passo Pitch P	Comb. Lacing	Dimensioni Dimensions				Resist. min trazione Min tensile strength kN		Massa Weight kg/m
	Std.	Sedis			b4	h2	d	e	Std.	SEDIS	
18100	BL422	LH08-22	12,7 (1/2")	2x2	10,90	11,5	5,12	2,05	22,2	27	0,58
18101	BL423	LH08-23		2x3	12,90				22,2	27	0,71
18102	BL434	LH08-34		3x4	17,10				33,4	40,5	1,00
18103	BL444	LH08-44		4x4	19,40				44,5	54	1,14
18104	BL446	LH08-46		4x6	23,40				44,5	54	1,42
18105	BL466	LH08-66		6x6	27,80				66,7	81	1,70
18106	BL488	LH08-88		8x8	36,25				89	108	2,30
18107	BL522	LH10-22	15,875 (5/8")	2x2	12,60	14,5	5,98	2,40	33,4	42,7	0,85
18108	BL523	LH10-23		2x3	15,10				33,4	43	1,05
18109	BL534	LH10-34		3x4	20,00				48,9	60	1,45
18110	BL544	LH10-44		4x4	22,30				66,7	80	1,70
18111	BL546	LH10-46		4x6	27,40				66,7	80	2,08
18112	BL566	LH10-66		6x6	32,20				100,1	128	2,50
18113	BL588	LH10-88		8x8	42,25				133,4	170,8	3,40
18114	BL622	LH12-22	19,05 (3/4")	2x2	17,20	18,1	7,97	3,30	48,9	65	1,42
18115	BL623	LH12-23		2x3	20,50				48,9	65	1,78
18116	BL634	LH12-34		3x4	27,10				75,6	97,5	2,35
18117	BL644	LH12-44		4x4	30,50				97,9	130	2,80
18118	BL646	LH12-46		4x6	37,25				97,9	130	3,40
18119	BL666	LH12-66		6x6	44,00				146,8	195	4,00
18120	BL688	LH12-88		8x8	57,25				195,7	260	5,70
18121	BL822	LH16-22	25,4 (1")	2x2	20,40	24,0	9,58	4,10	84,5	105	2,17
18122	BL823	LH16-23		2x3	24,60				84,5	105	2,71
18123	BL834	LH16-34		3x4	32,70				129	157	3,78
18124	BL844	LH16-44		4x4	36,75				169	210	4,35
18125	BL846	LH16-46		4x6	45,00				169	210	5,47
18126	BL866	LH16-66		6x6	52,80				253,6	310	6,55
18127	BL888	LH16-88		8x8	69,00				338,1	410	8,70
18128	BL1022	LH20-22	31,75 (1" 1/4)	2x2	24,40	29,6	11,16	4,90	115,6	140	3,48
18129	BL1023	LH20-23		2x3	29,40				115,6	140	4,35
18130	BL1034	LH20-34		3x4	39,20				182,4	230	6,03
18131	BL1044	LH20-44		4x4	44,25				231,3	280	6,90
18132	BL1046	LH20-46		4x6	54,00				231,3	280	8,60
18133	BL1066	LH20-66		6x6	63,80				347	420	10,30
18134	BL1088	LH20-88		8x8	83,50				462,6	560	13,70
18135	BL1222	LH24-22	38,1 (1" 1/2)	2x2	28,40	34,6	12,76	5,80	151,2	175	4,40
18136	BL1223	LH24-23		2x3	34,30				151,2	175	5,50
18137	BL1234	LH24-34		3x4	45,90				244,6	300	7,70
18138	BL1244	LH24-44		4x4	51,80				302,5	355	8,80
18139	BL1246	LH24-46		4x6	63,40				302,5	355	10,80
18140	BL1266	LH24-66		6x6	75,10				453,7	530	13,00
18141	BL1288	LH24-88		8x8	98,30				605	710	17,40
18142	BL1422	LH28-22	44,45 (1" 3/4)	2x2	32,00	42,0	14,33	6,55	191,3	220	6,30
18143	BL1423	LH28-23		2x3	38,70				191,3	220	7,85
18144	BL1434	LH28-34		3x4	51,80				315,8	375	10,80
18145	BL1444	LH28-44		4x4	58,50				382,6	440	12,60
18146	BL1446	LH28-46		4x6	71,50				382,6	440	15,70
18147	BL1466	LH28-66		6x6	84,60				578,3	685	18,80
18148	BL1488	LH28-88		8x8	111,00				765,1	910	25,10
18149	BL1622	LH32-22	50,8 (2")	2x2	36,20	48,3	17,52	7,50	289,1	320	8,30
18150	BL1623	LH32-23		2x3	43,80				289,1	320	10,40
18151	BL1634	LH32-34		3x4	58,80				440,4	480	14,60
18152	BL1644	LH32-44		4x4	66,50				578,3	640	16,70
18153	BL1646	LH32-46		4x6	81,30				578,3	640	20,80
18154	BL1666	LH32-66		6x6	96,50				857,4	960	25,00
18155	BL1688	LH32-88		8x8	126,50				1156,5	1280	33,30

Per le catene anticorrosione vedere nelle pagine successive. Look in the following pages for the corrosion-proof chains.

Serie

LL

sedis 

3

Dimensioni / Dimensions

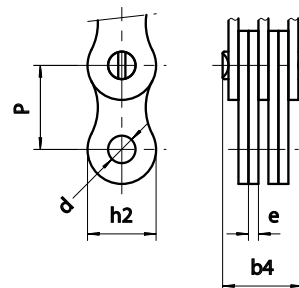

Art. Part no.	Tipo Type		Passo Pitch P	Comb. Lacing	Dimensioni Dimensions				Resist. min trazione Min tensile strength kN		Massa Weight kg/m				
	Std.	Sedis			b4	h2	d	e	Std.	SEDIS					
18000		J34	9,53 (3/8")	2x2	6,9	8,30	3,29	1,24		9,2	0,26				
18001		J38		4x4	12,0				18	0,50					
18002		JL44	12,7 (1/2")	2x2	6,9	8,30	3,66	0,93		8	0,17				
18003	LL08-22	J44		2x2	8,1				17,8	18,2	0,34				
18004	LL08-44	J48		4x4	13,0				31,1	36,4	0,66				
18005	LL08-66	J412		6x6	18,9				44,5	54,6	1,00				
18006	LL10-22	J54	15,875 (5/8")	2x2	9,3	12,10	5,10	1,65		22,2	23	0,44			
18007	LL10-44	J58		4x4	16,4				44,5	46	0,85				
18008	LL10-66	J512		6x6	22,8				66,7	69	1,30				
18009		J516		8x8	29,1					90	1,73				
18010		J524		12x12	42,8					138	2,50				
18011	LL12-22	J64		2x2	10,2					28,9	31	0,60			
18012	LL12-44	J68	4x4	17,8	14,30	5,74	1,85		57,8	62	1,18				
18013		J611	6x5	23,7					78	1,60					
18014	LL12-66	J612	6x6	25,5					86,7	94	1,74				
18014A		J613	6x7	27,4						94	1,90				
18015		J615	8x7	31,3						109	2,20				
18015A	LL12-88	J616	8x8	33,6						122	2,35				
18016		J617	9x8	35,0						125	2,50				
18016A	LL12-1010	J620	10x10	40,5						132,3	2,95				
18017	LL16-22	J84T	25,4 (1")	2x2				16,6	20,80	8,30	3,20		58	75	1,45
18018		J85T		3x2				20,0					75	1,79	
18019		J87T		3x4	26,4		110	2,51							
18020	LL16-44	J88T		4x4	29,6		116	150				2,85			
18021	LL16-66	J812T		6x6	42,4		174	210				4,20			
18022		J816T		8x8	55,2		300	5,70							
18023	LL20-22	J104T	31,75 (1" 1/4)	2x2	19,1	25,40	10,21	3,70		95	105	2,10			
18024	LL20-44	J108T		4x4	34,1					190	210	4,12			
18025	LL20-66	J1012T		6x6	48,9					285	315	6,19			
18026		J1016T		8x8	64,0					420	8,25				
18027	LL24-22	J1204T	38,1 (1" 1/2)	2x2	25,8	33,40	14,65	5,20		170	180	4,00			
18028	LL24-44	J1208T		4x4	46,8					340	360	8,00			
18029	LL24-66	J1212T		6x6	67,5					510	540	12,00			
18030		J1216T		8x8	88,1					720	720	16,00			
18031	LL28-22	J1404T	44,45 (1" 3/4)	2x2	31,7	33,50	15,92	6,55		200	235	6,00			
18032	LL28-44	J1408T		4x4	58,0					400	470	12,00			
18033	LL28-66	J1412T		6x6	84,2					600	705	17,00			
18034		J1416T		8x8	110,3					940	23,00				
18035	LL32-22	J1604T	50,8 (2")	2x2	30,7	42,29	17,83	6,20		260	270	6,50			
18036	LL32-44	J1608T		4x4	55,6					520	540	13,00			
18037	LL32-66	J1612T		6x6	80,5					780	810	19,00			
18038		J1616T		8x8	105,2					1080	1080	25,00			
18039	LL40-22	J2004T	63,5 (2" 1/2)	2x2	39,8	52,80	22,91	8,20		360	400	10,00			
18040	LL40-44	J2008T		4x4	72,8					720	800	19,50			
18041	LL40-66	J2012T		6x6	105,6					1080	1200	29,00			
18042		J2016T		8x8	138,4					1600	1600	39,00			
18043	LL48-22	J2404T	76,2 (3")	2x2	48,7	64,20	29,26	10,20		560	600	15,00			
18044	LL48-44	J2408T		4x4	89,7					1120	1200	29,50			
18045	LL48-66	J2412T		6x6	130,5					1680	1800	44,00			

Per le catene anticorrosione vedere nelle pagine successive.
Look in the following pages for the corrosion-proof chains.

CATENE ANTICORROSIONE DELTA-Z DELTA-Z ANTI-CORROSION CHAINS



Disponibili su richiesta.
Available upon request.

Caratteristiche:

- Resistenza alla corrosione.
- Maggiore durata.
- Stessa resistenza alla trazione delle catene standard.

Utilizzo:

- Industria alimentare.
- Applicazioni gravose in ambienti corrosivi (umidi, salini, marini).
- Lavaggi frequenti anche con solventi organici.

Characteristics:

- High resistance against corrosion.
- Longer lifetime.
- Same tensile strength as the standard leaf chains.

Usage:

- Food industry.
- Severe applications in corrosive environments (humid, salted, marine).
- Frequent washings even with organic solvents.

CALIBRI PER CATENE CHAIN WEAR GAUGE

Art. / Part no.	Descrizione / Description
18300	Calibro in alluminio per la misurazione dell'usura delle catene di sollevamento AL, BL (LH) e LL e a rulli. Aluminium wear gauge for the AL, BL (LH) and LL leaf chains and for the roller chains.



GIUNZIONI CATENE SOLLEVAMENTO LINKS FOR LEAF CHAINS



Art. Part no.	Tipo catena Chain type	
	Std.	Sedis
18020G	LL16-44	J88T
18021G	LL16-66	J816T
18108G	BL523	LH10-23
18109G	BL534	LH10-34
18115G	BL623	LH12-23
18116G	BL634	LH12-34
18122G	BL823	LH16-23
18123G	BL834	LH16-34
18124G	BL844	LH16-44
18129G	BL1023	LH20-23
18130G	BL1034	LH20-34
18137G	BL1234	LH24-34
18144G	BL1434	LH28-34

Utilizzo:

- Connessione catene di sollevamento a tiranti di tipo maschio.

Usage:

- Connections of leaf chains to male chain attachments

Consultateci per altri tipi non presenti nell'elenco
Contact us for other types

PERNI PER TIRANTI PINS FOR CHAIN ATTACHMENTS

sedis 

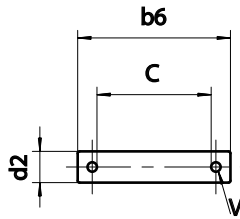

3

Art. Part no.	Tipo catena Chain type	d2	C	b6	V
18000P	J34	3,28			
18001P	J38	3,28			
18002P	JL44	3,65	6,1	13,4	1,2
18200P	AL422	3,97	10,0	17,9	1,6
18201P	AL444	3,97	16,2	24,1	1,6
18202P	AL466	3,97	22,6	30,5	1,6
18003P	LL08-22 J44	4,45	8,6	16,5	1,6
18004P	LL08-44 J48	4,45	13,9	21,8	1,6
18005P	LL08-66 J412	4,45	19,3	27,3	1,6
18006P	LL10-22 J54	5,08	10,5	18,4	1,6
18203P	AL522	5,08	12,0	21,1	1,6
18100P	BL422 LH08-22	5,08	13,0	21,2	1,6
18007P	LL10-44 J58	5,08	17,2	25,5	1,6
18102P	BL423 LH08-23	5,08	18,0	26,1	1,6
18102P	BL434 LH08-34	5,08	18,0	26,1	1,6
18204P	AL544	5,08	21,5	29,5	1,6
18103P	BL444 LH08-44	5,08	22,0	30,5	1,6
18008P	LL10-66 J512	5,08	23,9	32,0	1,6
18104P	BL446 LH08-46	5,08	25,1	33,1	1,6
18205P	AL566	5,08	29,7	37,9	1,6
18105P	BL466 LH08-66	5,08	30,0	38,5	1,6
18009P	J516	5,08	30,5	38,7	1,6
18106P	BL488 LH08-88	5,08	39,0	47,5	1,6
18010P	J524	5,08	43,8	52,0	1,6
18011P	LL12-22 J64	5,72	11,7	19,8	1,6
18012P	LL12-44 J68	5,72	19,4	27,5	1,6
18013P	J611	5,72	25,0	33,1	1,6
18014P	LL12-66 J612	5,72	27,2	35,3	1,6
18014PF	LL12-66 J612	5,72	32,0	38,0	1,6
18015P	J615	5,72	33,0	42,0	1,6
18016P	J617	5,72	37,0	46,0	1,6
18206P	AL622	5,95	15,0	23,5	1,6
18107P	BL522 LH10-22	5,95	18,0	26,1	1,6
18107P	BL523 LH10-23	5,95	18,0	26,1	1,6
18109P	BL534 LH10-34	5,95	25,0	33,1	1,6
18109P	BL544 LH10-44	5,95	25,0	33,1	1,6
18109P	AL644	5,95	25,0	33,1	1,6
18111P	BL546 LH10-46	5,95	30,0	38,1	1,6
18208P	AL666	5,95	34,6	43,1	1,6
18112P	BL566 LH10-66	5,95	35,0	43,5	1,6
18113P	BL588 LH10-88	5,95	45,0	53,5	1,6
18113P	AL688	5,95	45,0	53,5	1,6
18209P	AL822	7,92	20,0	30,2	2,0

Art. Part no.	Tipo catena Chain type	d2	C	b6	V
18114P	BL622 LH12-22	7,92	22,0	31,2	2,0
18115P	BL623 LH12-23	7,92	26,0	35,2	2,0
18116P	BL634 LH12-34	7,92	30,0	39,2	2,0
18210P	AL844	7,92	33,3	43,5	2,0
18117P	BL644 LH12-44	7,92	35,0	44,2	2,0
18118P	BL646 LH12-46	7,92	45,0	54,5	2,0
18211P	AL866	7,92	46,5	56,7	2,0
18119P	BL666 LH12-66	7,92	48,0	57,5	2,0
18120P	BL688 LH12-88	7,92	65,0	74,5	2,0
18017P	LL16-22 J84T	8,28	19,4	30,8	2,5
18018P	J85T	8,28	22,3	34,0	2,5
18019P	J87T	8,28	29,7	40,4	2,5
18020P	LL16-44 J88T	8,28	32,3	43,6	2,5
18021P	LL16-66 J812T	8,28	45,0	58,5	2,5
18022P	J816T	8,28	61,7	75,0	2,5
18212P	AL1022	9,53	25,0	36,5	2,5
18121P	BL822 LH16-22	9,53	25,0	35,3	2,5
18122P	BL823 LH16-23	9,53	30,0	40,2	2,5
18123P	BL834 LH16-34	9,53	35,0	45,2	2,5
18213P	AL1044	9,53	41,5	53,0	2,5
18124P	BL844 LH16-44	9,53	42,0	52,5	2,5
18125P	BL846 LH16-46	9,53	48,0	58,4	2,5
18126P	BL866 LH16-66	9,53	55,0	65,5	2,5
18214P	AL1066	9,53	58,0	69,8	2,5
18127P	BL888 LH16-88	9,53	75,0	85,6	2,5
18023P	LL20-22 J104T	10,18	22,5	35,7	3,2
18024P	LL20-44 J108T	10,18	37,3	50,6	3,2
18025P	LL20-66 J1012T	10,18	52,1	65,5	3,2
18026P	J1016T	10,18	68,0	81,4	3,2
18128P	BL1022 LH20-22	11,10	30,0	44,3	3,2
18128P	AL1222	11,10	30,0	44,5	3,2
18129P	BL1023 LH20-23	11,10	35,0	49,2	3,2
18130P	BL1034 LH20-34	11,10	45,0	59,2	3,2
18131P	BL1044 LH20-44	11,10	48,0	62,5	3,2
18216P	AL1244 AL1244	11,10	48,5	64,0	3,2
18132P	BL1046 LH20-46	11,10	65,0	79,3	3,2
18217P	AL1266	11,10	68,9	83,5	3,2
18133P	BL1066 LH20-66	11,10	70,0	84,5	3,2
18134P	BL1088 LH20-88	11,10	90,0	104,7	3,2
18135P	BL1222 LH24-22	12,70	35,0	50,3	3,2
18218P	AL1422	12,70	35,5	50,5	3,2
18136P	BL1223 LH24-23	12,70	42,0	57,2	3,2
18137P	BL1234 LH24-34	12,70	55,0	70,3	3,2

Art. Part no.	Tipo catena Chain type	d2	C	b6	V
18219P	AL1444	12,70	58,5	74,0	3,2
18138P	BL1244 LH24-44	12,70	60,0	75,3	3,2
18139P	BL1246 LH24-46	12,70	75,0	90,3	3,2
18220P	AL1466	12,70	81,6	97,0	3,2
18140P	BL1266 LH24-66	12,70	85,0	100,5	3,2
18141P	BL1288 LH24-88	12,70	110,0	125,5	3,2
18221P	AL1622	14,27	40,0	56,0	3,2
18142P	BL1422 LH28-22	14,27	42,0	58,2	3,2
18143P	BL1423 LH28-23	14,27	48,0	64,3	3,2
18144P	BL1434 LH28-34	14,27	60,0	76,3	3,2
18222P	AL1644	14,27	66,5	82,5	3,2
18145P	BL1444 LH28-44	14,27	70,0	86,4	3,2
18146P	BL1446 LH28-46	14,27	85,0	101,5	3,2
18223P	AL1666	14,27	92,4	108,5	3,2
18147P	BL1466 LH28-66	14,27	95,0	111,5	3,2
18148P	BL1488 LH28-88	14,27	120,0	136,5	3,2
18027P	LL24-22 J1204T	14,62	31,6	47,2	3,2
18028P	LL24-44 J1208T	14,62	52,4	68,2	3,2
18029P	LL24-66 J1212T	14,62	73,0	88,8	3,2
18030P	J1216T	14,62	94,0	109,5	3,2
18031P	LL28-22 J1404T	15,89	39,7	56,8	4,0
18032P	LL28-44 J1408T	15,89	66,0	83,2	4,0
18033P	LL28-66 J1412T	15,89	92,0	109,2	4,0
18034P	J1416T	15,89	118,2	135,5	4,0
18149P	BL1622 LH32-22	17,46	45,0	63,3	4,0
18150P	BL1623 LH32-23	17,46	55,0	73,2	4,0
18151P	BL1634 LH32-34	17,46	70,0	88,3	4,0
18152P	BL1644 LH32-44	17,46	80,0	98,4	4,0
18153P	BL1646 LH32-46	17,46	95,0	113,5	4,0
18154P	BL1666 LH32-66	17,46	110,0	128,7	4,0
18155P	BL1688 LH32-88	17,46	140,0	159,0	4,0
18035P	LL32-22 J1604T	17,80	38,2	56,2	4,0
18036P	LL32-44 J1608T	17,80	63,0	81,1	4,0
18037P	LL32-66 J1612T	17,80	87,8	106,0	4,0
18038P	J1616T	17,80	112,5	130,8	4,0
18039P	LL40-22 J2004T	22,88	49,7	72,0	5,0
18040P	LL40-44 J2008T	22,88	82,6	105,0	5,0
18041P	LL40-66 J2012T	22,88	115,4	138,0	5,0
18042P	J2016T	22,88	148,2	171,0	5,0
18043P	LL48-22 J2404T	29,22	60,6	86,0	6,3
18044P	LL48-44 J2408T	29,22	101,8	127,5	6,3
18045P	LL48-66 J2412T	29,22	144,8	170,5	6,3

TIRANTI PER CATENE SOLLEVAMENTO CHAIN END ATTACHMENTS

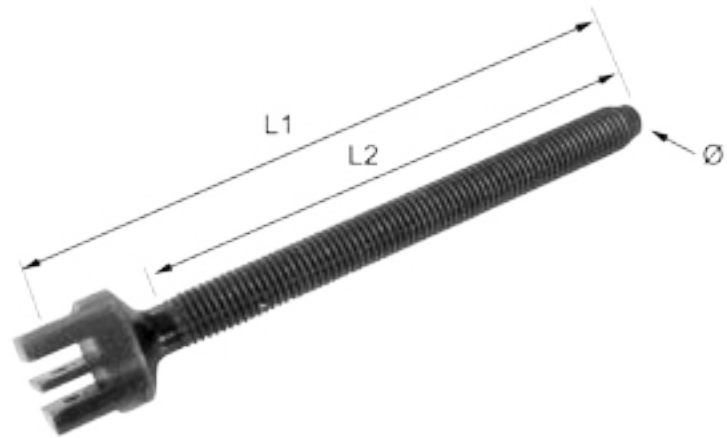

Tiranti SEDIS standard a pettine femmina per catene di sollevamento.
SEDIS standard female chain attachments.

Art. Part no.	Tipo catena Chain type	L1	L2	Ø
18007K	LL10-44 J58	172	140	M14
18008K	LL10-66 J512	172	140	M14
18012K	LL12-44 J68	160	130	M14
18014K	LL12-66 J612	160	125	M16
18020K	LL16-44 J88T	175	140	M20
18021K	LL16-66 J812T	172	135	M20
18024K	LL20-44 J108T	194	135	M24
18025K	LL20-66 J1012T	165	115	M24
18108K	BL523 LH10-23	172	140	M14
18109K	BL534 LH10-34	172	140	M14
18110K	BL544 LH10-44 AL644	172	140	M14

Art. Part no.	Tipo catena Chain type	L1	L2	Ø
18111K	BL546 LH10-46	172	140	M16
18112K	BL566 LH10-66 AL666	172	140	M20
18115K	BL623 LH12-23	178	140	M20
18116K	BL634 LH12-34	178	140	M20
18117K	BL644 LH12-44 AL844	178	140	M20
18118K	BL646 LH12-46	178	140	M20
18119K	BL666 LH12-66 AL866	188	135	M20
18122K	BL823 LH16-23	178	140	M20
18123K	BL834 LH16-34	178	140	M20
18125K	BL846 LH16-46	178	140	M20

Tiranti speciali per catene.
Special chain attachments.

Art. Part no.	Tipo catena Chain type	L1	L2	Ø	Tipo attacco Attach. type	Adatt. / Applic.
18020HST	LL16-44	208	172	M16	Maschio / Male	STILL OM
18104HL	BL446 LH08-46	142	76	M14	Femmina / Female	
18105HL	BL466 LH08-66 AL566	172	98	M18	Femmina / Female	
18110HL	BL544 LH10-66 AL644	150	100	M14	Femmina / Female	
18112HL	BL566 LH10-66 AL666	212	140	M18	Femmina / Female	
18115HST	BL623 LH12-23	168	134	M12	Femmina / Female	STILL OM
18115HL	BL623 LH12-23	140	80	M14	Femmina / Female	
18116HL	BL634 LH12-34	140	88	M16	Femmina / Female	
18117HL	BL644 LH12-44 AL844	170	96	M16	Femmina / Female	
18124HL	BL844 LH16-44 AL1044	170	100	M20	Femmina / Female	

Consultateci per altre misure non presenti nell'elenco
Contact us for other types

CATENE CON PLASTICHE LATERALI CHAINS WITH PLASTIC SIDEWALLS

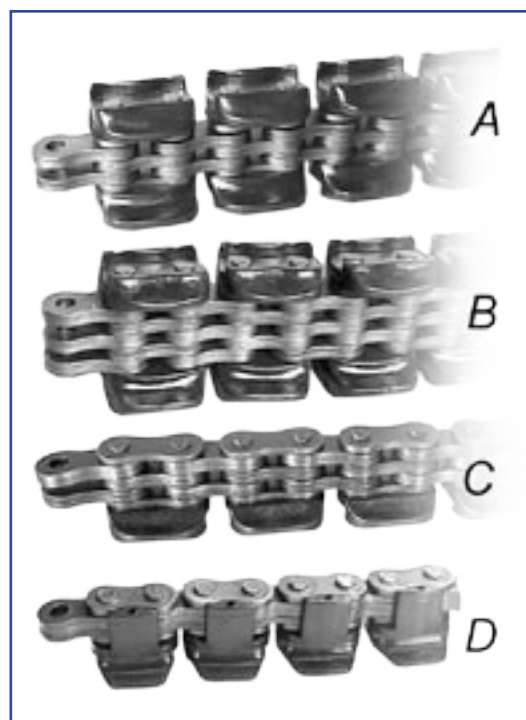
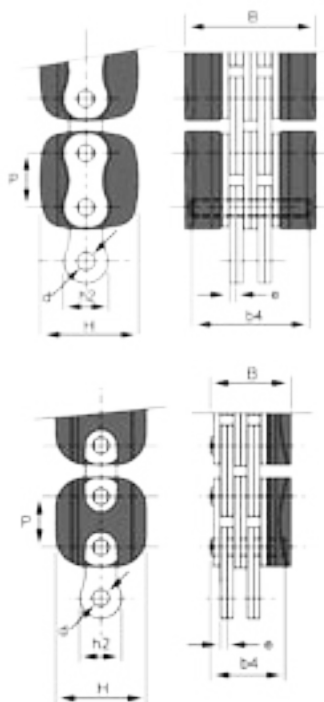

3

CATENE CON SPALLE LATERALI IN PLASTICA LEAF CHAINS WITH PLASTIC SIDEWALLS

Art. Part no.	Adattabile Application	Passo Pitch P	Comb. Lacing	Dimensioni Dimensions						Spalle lat. Sideplates	Massa Weight kg/m	Fig.
				b4	B	H	h2	d	e			
18503E	LINDE 080	19,05 (3/4")	2x3	26,30	31,70	41,50	17,80	7,95	3,25	1	2,45	D
18502E	LINDE 110 STILL OM	25,4 (1")	4x4	36,00	37,80	44,70	20,30	8,30	3,10	1	3,44	C
18500E	LINDE 105 STILL OM		4x4	52,60	59,00	45,90				2	4,35	A
18501E	LINDE 106 STILL OM		4x6	59,90	65,40	46,20				2	5,10	B
18505E	LINDE 111		4x6	59,60	66,40	46,20				23,8	9,53	4,10

CATENE CON PLASTICHE CENTRALI CHAINS WITH CENTRAL INSERTS

3

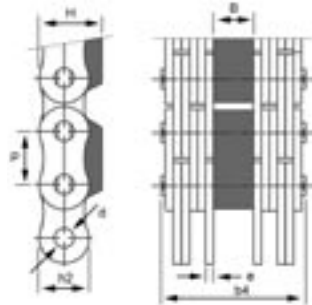

CATENE CON INSERTO CENTRALE IN PLASTICA LEAF CHAINS WITH PLASTIC INSERTS

Art. Part no.	Adattabile Application	Passo Pitch P	Comb. Lacing	Dimensioni Dimensions						Massa Weight kg/m	Fig.
				b4	B	H	h2	d	e		
18510E	STILL JUNGHEINRICH	19,05 (3/4")	6x6	36,0	3,7	21	18,2	6,5	2,3	3,30	A
18516E	JUNGHEINRICH	19,05 (3/4")	8x8	46,0	3,7	22	18,2	6,5	2,3	4,70	B
18513E	JUNGHEINRICH STEINBOCK	25,4 (1")	3x4	40,0	7,0	30,0	24,0	9,53	4	4,53	C
18514E	JUNGHEINRICH STEINBOCK	25,4 (1")	4x4	44,6	7,0	25,6	23,6	9,53	4	5,15	D
18511E	STILL OM	25,4 (1")	4x4	44,0	7,1	28,5	24,0	9,53	4	5,18	E
18508E	LINDE 109	25,4 (1")	4x4	57,6	19,8	27,5	23,6	9,53	4	5,53	F
18507E	LINDE 116 dente doppio / twin teeth	25,4 (1")	4x4	61,4	23,5	28,5	23,8	9,53	4	5,80	G
18504E	LINDE 104 STILL OM	25,4 (1")	6x6	68,5	14,5	27	23,8	9,53	3,9	7,87	H
18506E	LINDE 108	25,4 (1")	8x8	78,1	7,1	29	23,8	9,53	3,9	10,50	I
18509	LINDE 123	44,45 (1" 3/4)	6x6	97,2	9,4	41,0	36,9	15,9	6,5	17,00	J

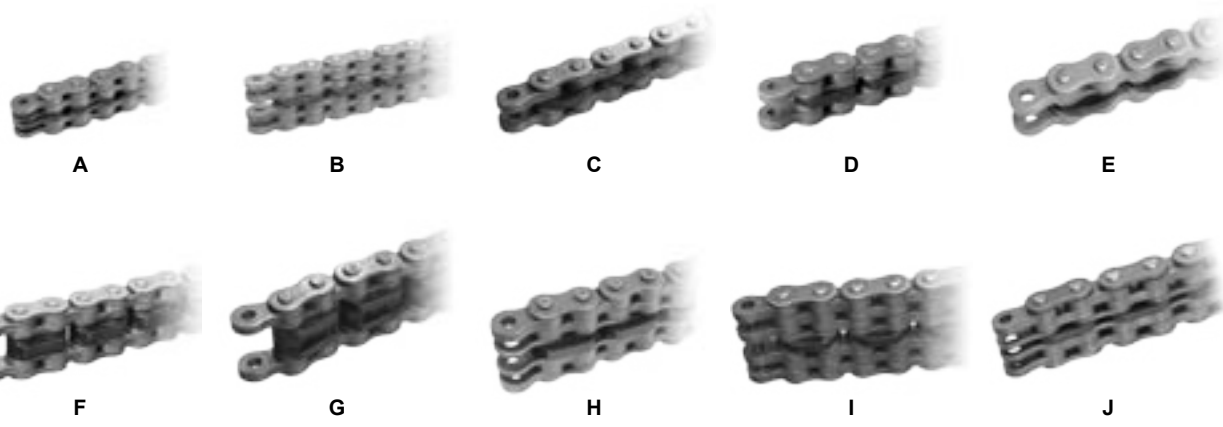

CATENE CON GUIDA TUBO A "C" CHAINS WITH "C" HOSE GUIDE

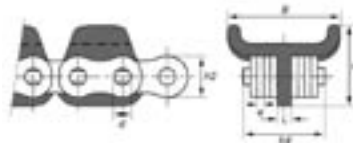

3

CATENE CON GUIDA TUBI A "C" IN PLASTICA LEAF CHAINS WITH "C" SHAPED HOSE GUIDE

Art. Part no.	Adattabile Application	Passo Pitch P	Comb. Lacing	Dimensioni Dimensions								Massa Weight kg/m
				b4	B	L	H	h2	d	e		
18512E	BL544 TOYOTA TRAIGO CESAB	15,875 (5/8")	4x4	27,5	39,5	5,2	30,0	14,6	5,95	2,4	2,02	
18515	BL644 TOYOTA TONERO CESAB M330	19,05 (3/4")	4x4	35,9	40,0	6,5	34,6	17,9	7,92	3,3	3,20	



CATENE FUORI STANDARD WORKS STANDARD CHAINS

CATENE FUORI STANDARD WORKS STANDARD CHAINS

Art. Part no.	Adattabile Application	Passo Pitch P	Comb. Lacing	Dimensioni Dimensions				Massa Weight kg/m
				b4	h2	d	e	
18118W	STILL LINDE 127	19,05 (3/4")	4x6 special	36,0	17,8	7,92	3,2	3,43
18510A	JUNGHEINRICH	19,05 (3/4")	6x6	32,5	18,2	6,5	2,3	3,10

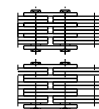
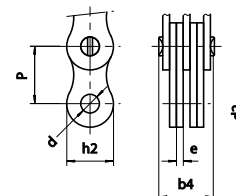

PERNI SPECIALI SPECIAL CHAIN PINS

PERNI CATENA SPECIALI SPECIAL CHAIN PINS

Art. Part no.	Tipo / Type	Per catena For chain	Dimensioni Dimensions			Fig.
			Ø	L	C	
18512PT	Con 1 coppiglia With 1 cotter pin	18512E	5,95	36,5	30	B
18510P	Con 2 coppiglie With 2 cotter pins	18510E 18510A 18516E	6,45	49	40,5	A
18516P	Con 2 coppiglie With 2 cotter pins	18516	6,45	58,9	51,5	A
18500P	Da ribadire Press-fit	18500E 18502E	8,25	37	-	C
18501P	Da ribadire Press-fit	18500E 18501E	8,25	50	-	C
18126PC	Con 1 coppiglia With 1 cotter pin	18126	9,43	67	63	B
18504P	Da ribadire Press-fit	18504E 18507E 18508E	9,58	70	-	C
18504PC	Con 2 coppiglie With 2 cotter pins	18504E	9,36	82	75	A
18506P	Da ribadire Press-fit	18506E	9,58	82	-	C

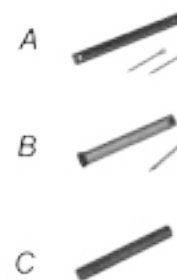

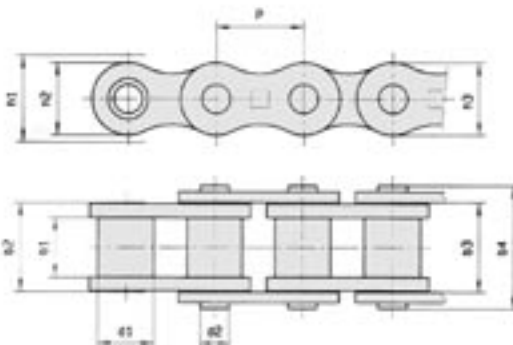

CATENE A RULLI - SERIE B ROLLER CHAINS - B TYPE

Art. Part no.	Tipo Type		Passo Pitch P	d1 max	Larghezza catena Chain width			d2 max	h2 max	S mm ²	Resist. alla trazione Tensile strength kN			Massa Weight kg/m
	Std.	Sedis			b1 min	b4 max	b7 max				Std.	SEDIS min	SEDIS med/ave	
18400	06 B-1	3N	9,525 (3/8")	6,35	5,72	13,50	2,10	3,27	8,23	28	8,9	9,0	10,3	0,40
18403	08 B-1	7N	12,70 (1/2")	8,51	7,75	16,60	1,50	4,45	11,80	50	17,8	18,2	20,4	0,69
18404	10 B-1	11N	15,875 (5/8")	10,16	9,65	19,00	1,50	5,08	13,70	67	22,2	23,0	27,2	0,85
18405	12 B-1	13N	19,05 (3/4")	12,07	11,68	22,30	1,50	5,72	16,20	88	28,9	30,5	34,8	1,18
18406	16 B-1	15T	25,4 (1")	15,88	17,02	35,10	3,00	8,28	20,80	205	60,0	66,0	76,3	2,66
18407	20 B-1	17T	31,75 (1" 1/4)	19,05	19,56	40,50	6,10	10,19	25,40	292	95,0	105,0	114	3,72
18408	24 B-1	18T	38,10 (1" 1/2)	25,40	25,40	53,10	6,60	14,63	32,30	550	160,0	180,0	198	7,05



GIUNZIONI SINGOLE / SINGLE STRAND LINKS

Art. Part no.	Per catena For chain		Descrizione Description
18400G	06 B-1	3N	Maglia di giunzione con molla ad attacco rapido, tipo 206, trattamento Delta. Roller chain link, type 206, Delta treatment.
18403G	08 B-1	7N	Maglia di giunzione con molla ad attacco rapido, tipo 206, trattamento Delta. Roller chain link, type 206, Delta treatment.
18404G	10 B-1	11N	Maglia di giunzione con molla ad attacco rapido, tipo 206, trattamento Delta. Roller chain link, type 206, Delta treatment.
18405G	12 B-1	13N	Maglia di giunzione con molla ad attacco rapido, tipo 206, trattamento Delta. Roller chain link, type 206, Delta treatment.
18406G	16 B-1	15T	Maglia di giunzione con molla ad attacco rapido, tipo 206, trattamento Delta. Roller chain link, type 206, Delta treatment.
18407G	20 B-1	17T	Maglia di giunzione con coppiglie, tipo 208, trattamento Delta. Roller chain link, type 208, Delta treatment.
18408G	24 B-1	18T	Maglia di giunzione con coppiglie, tipo 208, trattamento Delta. Roller chain link, type 208, Delta treatment.

Consultateci per altri tipi non presenti nell'elenco
Contact us for other types

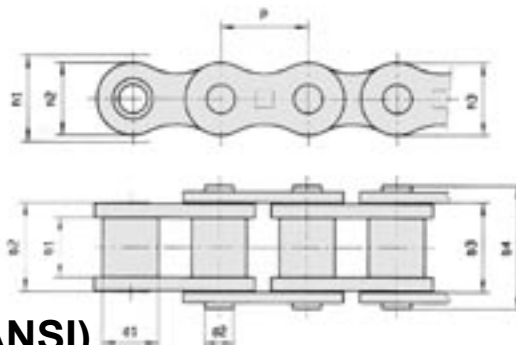

CATENE A RULLI - SERIE A (ANSI) ROLLER CHAINS - A TYPE (ANSI)

Art. Part no.	Tipo Type		Passo Pitch P	d1 max	Larghezza catena Chain width			d2 max	h2 max	S mm ²	Resist. alla trazione Tensile strength kN			Massa Weight kg/m
	Std.	Sedis Ansi			b1 min	b4 max	b7 max				Std.	SEDIS min	SEDIS med/ave	
18450	08 A-1	40-1	12,70 (1/2")	7,93	7,85	16,30	1,5	3,98	11,50	44	13,8	16,5	19,2	0,60
18451	10 A-1	50-1	15,875 (5/8")	10,15	9,55	20,45	1,5	5,09	13,70	69	21,8	27,0	31,4	1,00
18452	12 A-1	60-1	19,05 (3/4")	11,91	12,65	25,40	4,0	5,96	16,20	105	31,3	38,0	43,8	1,36
18453	16 A-1	80-1	25,4 (1")	15,88	15,87	32,80	4,0	7,94	20,80	178	55,60	62,0	77,2	2,58
18453R	16 A-1	80-1	25,4 (1")	15,88	15,87	33,05	4,0	7,92	24,00	178	55,6	-	-	2,60
18454	20 A-1	100-1	31,75 (1" 1/4)	19,05	19,05	39,60	6,1	9,53	25,40	260	87,0	99,0	110,0	3,88
18455	24 A-1	120-1	38,10 (1" 1/2)	22,22	25,40	49,60	6,6	11,10	35,20	392	125,0	140,0	168,0	5,56



GIUNZIONI SINGOLE / SINGLE STRAND LINKS

Art. Part no.	Per catena For chain	Descrizione Description
18450G	08 A-1 40-1	Maglia di giunzione con molla ad attacco rapido, tipo 206, trattamento Delta. <i>Roller chain link, type 206, Delta treatment.</i>
18451G	10 A-1 50-1	Maglia di giunzione con molla ad attacco rapido, tipo 206, trattamento Delta. <i>Roller chain link, type 206, Delta treatment.</i>
18452G	12 A-1 60-1	Maglia di giunzione con molla ad attacco rapido, tipo 206, trattamento Delta. <i>Roller chain link, type 206, Delta treatment.</i>
18453G	16 A-1 80-1	Maglia di giunzione con molla ad attacco rapido, tipo 206, trattamento Delta. <i>Roller chain link, type 206, Delta treatment.</i>
18454G	20 A-1 100-1	Maglia di giunzione con coppie, tipo 208, trattamento Delta. <i>Roller chain link, type 208, Delta treatment.</i>
18455G	24 A-1 120-1	Maglia di giunzione con coppie, tipo 208, trattamento Delta. <i>Roller chain link, type 208, Delta treatment.</i>

Consultateci per altri tipi non presenti nell'elenco
Contact us for other types

